



Visualizer Shooting Guide

Receiving an error?
See "Trouble Shooting for Taking a Selfie"



1. Five Steps to Take a Better Selfie

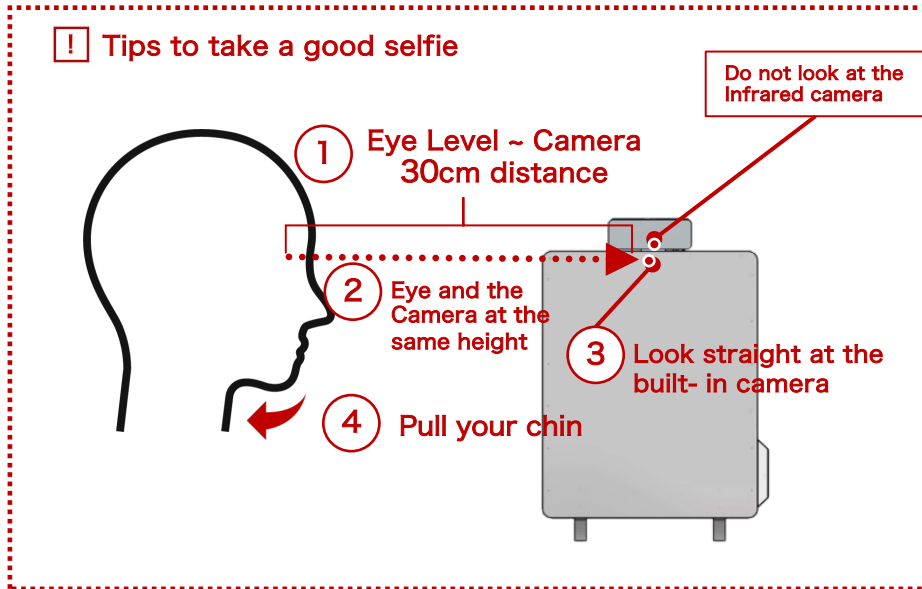

- ① **Eye Level ~ Camera must be 30cm distance**
If using 13inch mirror: 30cm
If using 21inch mirror: 35cm
*You may receive an error when you are 40cm away from the mirror.
- ② **Eyes and the Camera at the same height**
- ③ **Look straight at the built-in camera**
- ④ **Pull your chin**
- ⑤ **Freeze and capture**

2. Others

- **Do not move while taking a selfie**
 - The camera will automatically focus on to user's face. Please do not move a face or hand while taking a selfie, otherwise the camera would not be able to focus.
- **Do not take a picture in a dark place**
 - **Camera would not be able to focus** into the face, when the picture is taken in the dark environment with bright light.
 - Also, you will get better result when the picture is taken in this kind of environment, since the camera tries to adjust the picture.
- **Take a selfie after it is on focus.**
 - You may not adjust the focus manually.